

Maine-ly Docks

44 Main St.
OAKLAND, ME 04963 US
2076491882
shawn@mainelydocks.com

Estimate

ADDRESS

Richard LaBelle
Town of Norridgewock
16 Perkins St
P.O. Box 7
Norridgewock, ME 04957

SHIP TO

Richard LaBelle
Town of Norridgewock
Norridgewock, ME 04957

ESTIMATE # 1162**DATE** 09/05/2023**EXPIRATION DATE** 10/05/2023**SALES REP**

Scott

CUSTOMER TELEPHONE NUMBER

207-634-2252

DATE	ACTIVITY	DESCRIPTION	AMOUNT
09/05/2023	6x9 Frame w/Aluminum Decking	Includes, Fixed Al Decking, 2 poles up to 10' in length, 2 Foot pads and 2 connector brackets where applicable, brackets can be welded in place upon request., 16 @ \$1,775.00	28,400.00
	Custom Fabrication	Anchor connector under center of dock, 16 @ \$30.00	480.00
	Stairs Custom Built	13 Stairs, 48" wide, with 3'x4' landing, SureStep treads, Includes 2 side handrails and a middle rail., 1 @ \$3,799.00	3,799.00
	Deep Water Brace	4 Std Braces and 2 Corner Braces, 6 @ \$200.00	1,200.00
	Installation	Dock Sections, 16 @ \$165.00	2,640.00
	Installation	Stairs, 1 @ \$330.00	330.00
		This bid does not include weighted pads for docks, placement of pads or connection of weight to dock sections. Civic Discount of 10% will be calculated into the final price,	

Richard, thank you for the opportunity to bid this project. Delivery schedule is based on the town's needs, We do request a 4-week lead time. Upon Town approval of proposal, a 25% down is requested to hold the pricing, remainder billed on delivery.
References: EJ Fabian, Beckett Family Services

SUBTOTAL	36,849.00
DISCOUNT 10%	-3,684.90
TOTAL	\$33,164.10

Accepted By

Accepted Date

Richard LaBelle

From: Chris Bilodeau <chris@dockguys.com>
Sent: Wednesday, September 13, 2023 11:34 AM
To: Richard LaBelle
Subject: Oosoola Park Dock and Stair Quotes
Attachments: Oosoola Park Config.pdf; Oosoola Park Multinautic 9-13-23.pdf; Oosoola Park Bertrand 9-13-23.pdf

Hi Richard,

We really appreciate the opportunity to quote this project.

I have attached two quotes and a scaled drawing of the configuration used for both.
The two quotes are intended to give you a range of price depending upon the structure strength and decking choice.

One quote is using Bertrand Docks with cedar wood decking.
Each section of Bertrand Docks come with the connection hardware, two 6' posts, two 7" square aluminum base plates & two blue safety caps.
The frames are 4" tall marine grade aluminum with stainless set screws and weigh 84 lbs.
The posts are 1.25" ID schedule 20 galv. steel.

The other quote is using Multinautic Docks with synthetic Lumberock decking that has a limited lifetime warrantee.
These sections only come with black filler caps that plug unused leg sockets.
The frames are 7" tall marine grade aluminum with stainless set screws and weigh 145 lbs.
The posts are 1.5" ID schedule 40 galv. steel and are intended to be driven 2' into the river bed.

We do offer assembly and installation.
The cost for the Bertrand would be - \$2,700
The cost for Multinautic would be - \$3,900

We have done several commercial projects in recent years. There are 5 examples featured at the bottom of gallery page of our website. Here is a link:
<https://dockguys.com/maine-docks.php>

The most recent commercial project is not featured on the website yet.
This 6' wide by 520' long boardwalk was completed in August for the Viles Arboretum in Augusta.
My contact is Ryan Martin, the Executive Director.
I would like to invite you to the ribbon cutting ceremony on Saturday 9/23.
Here is a link:
<https://vilesarboretum.org/about/blog/new-boardwalk-now-open-at-viles-arboretum>

Please feel free to contact me with any questions.

Thanks,

Chris Bilodeau

Phone: (207) 873-7198
www.dockguys.com

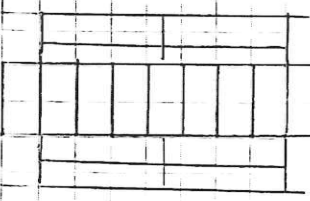
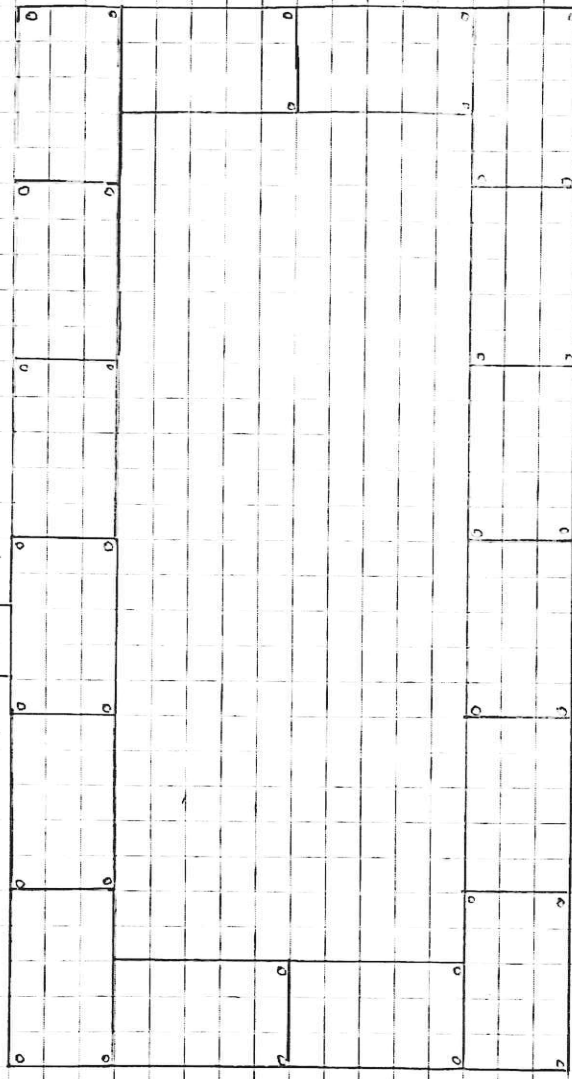



PO Box 1253
Waterville, Maine 04903-1253
(207) 873-7198

Quote #1501

09/13/2023 09:34:33 AM

Customer:

Town of Norridgewock
Richard LaBelle, Town Manager
16 Perkins St.
Norridgewock, ME 04957
Employee: Chris Bilodeau

Item #	Item/Labor	Qty	Each	Total Price
QPC-0610	Bertrand Dock 6' X 10' Cedar Decking	16	1,521.00	24,336.00
0703-6	Bertrand Post 6' - 1 5/8"	2	39.67	79.34
0702-T	Bertrand 7" X 7" bottom plate with open bottom	1	38.57	38.57
0704	Bertrand Post cap - blue	2	3.31	6.62
0723	Bertrand Cap 2" x 2" - BLACK	30	3.31	99.30
0713	Bertrand stabilizer 6'	24	67.22	1,613.28
0714-D	Bertrand Side Stabilizer 4' (1/2 post, 1/2 rail)	12	67.22	806.64
12003	Multinautic Anchor chain plate (1/4" thick)	16	19.89	318.24
FD	Freight + Delivery	1	1,950.00	1,950.00
	8' Post Exchange	4	4 x \$13.00	52.00
	10' Post Exchange	9	9 x \$26.00	234.00
	12' Post Exchange	7	7 x \$53.00	371.00
	4' wide 17 Step Aluminum Stairs with Two Handrails	1	1 x \$5525.00	5,525.00
			Labor	0.00
			Parts	35,429.99
			Tax	0.00
			Total	\$35,429.99

Notes:

50% Deposit - \$17,714.99

This quote is valid for 30 days
If you are in acceptance of this quote please sign and return a copy
Also required to initiate this order is the 50% deposit above

X _____
Town of Norridgewock & Date



PO Box 1253
Waterville, Maine 04903-1253
(207) 873-7198

Quote #1502

09/13/2023 10:06:00 AM

Customer:

Town of Norridgewock
Richard LaBelle, Town Manager
16 Perkins St.
Norridgewock, ME 04957
Employee: Chris Bilodeau

Item #	Item/Labor	Qty	Each	Total Price
MN610LR-P	Multinautic 6x10 with Lumberock - Putty	16	2,449.00	39,184.00
32300	J-Bracket	32	24.00	768.00
50125-7	Dock Guys 1 1/2" Galv Pipe 7 feet	7	56.00	392.00
50125-8	Dock Guys 1 1/2" Galv Pipe 8 feet	7	64.00	448.00
50125-10-6	Dock Guys 1 1/2" Galv Pipe 10 feet 6 Inches	4	84.00	336.00
50125-12	Dock Guys 1 1/2" Galv Pipe 12 feet	9	96.00	864.00
50125-14	Dock Guys 1 1/2" Galv Pipe 14 feet	7	112.00	784.00
50127	Safety Cap 1 1/2" pipe	34	6.00	204.00
11108	Multinautic Base plate 6" x 12", galvanised steel	34	26.99	917.66
30106	Dock Guys Small 6' Cross Brace	6	100.00	600.00
30206	Dock Guys Medium 6' Cross Brace	4	110.00	440.00
30306	Dock Guys Large 6' Cross Brace	14	120.00	1,680.00
30100	Dock Guys Small Back/Corner Brace	4	100.00	400.00
30200	Dock Guys Medium Back/Corner Brace	4	110.00	440.00
30300	Dock Guys Large Back/Corner Brace	8	120.00	960.00
12003	Multinautic Anchor chain plate (1/4" thick)	16	19.89	318.24
FD	Freight + Delivery	1	3,250.00	3,250.00
	4' wide 17 Step Aluminum Stairs with Two Handrails	1	1 x \$5525.00	5,525.00
Labor				0.00
Parts				57,510.90
Tax				24.20
Total				\$57,535.10

Notes:

50% Deposit - \$28,767.55

This quote is valid for 30 days
If you are in acceptance of this quote please sign and return a copy

Also required to initiate this order is the 50% deposit above

X _____
Town of Norridgewock & Date

Richard LaBelle

From: Lindsay Carter <lcarter@greatnortherndocks.com>
Sent: Thursday, September 7, 2023 11:44 AM
To: Richard LaBelle
Subject: Town of Norridgewock - Oosoola Park Dock Bid Submittal
Attachments: Town of Norridgewock - Oosoola Park Dock Proposal - Option 1.pdf; Drawing for Option 1 - Oosoola Park.pdf; Town of Norridgewock - Oosoola Park Dock Proposal - Option 2.pdf; Drawing for Option 2 - Oosoola Park.pdf; Town of Norridgewock - Oosoola Park Dock Proposal - Option 3.pdf; Drawing for Option 3 - Oosoola Park.pdf; Town of Norridgewock - Oosoola Park Dock Proposal - Option 4.pdf; Drawing for Option 4 - Oosoola Park.pdf

Good Morning Richard,

Thank you for reaching out in regards to the opportunity to bid on the Town of Norridgewock – Oosoola Park Dock project.

This estimate does not include a stair bid. Our stairs are only manufactured in 3' wide options. I can provide additional pricing for our stairs if you are interested.

I would need the vertical drop measurement to provide those. Unfortunately it is our very busy survey season this time of the year so I was not able to free up anyone from my survey team to make the travel to measure for the stairs.

Let me know if as you review these drawings and estimates any questions arise. I wanted to give you 4 different options without knowing what your budget might include.

Our Duralite is our more rugged, heavy duty dock made with our 6" proprietary extrusion and can be in up to 10' water depths. Our Featherlite is our lighter-duty line that has a 5" proprietary extrusion and performs best in up to 8' water depths. Both come with a 15 year warranty. The SunWalk perforated decking comes with a 12 year manufacturer's warranty. This is the most slip-resistant decking and the lowest maintenance which is why it is preferred in public spaces. This decking is also preferred on rivers and in tidal areas where there may be concerns about occasional flooding.

We manufacture our products right here at our factory in Naples, Maine by an elite group of experienced craftsmen led by our master welder. We have been in business for over 40 years and are now into the 3rd generation family-owned business.

Our quality is unmatched. Our designs are often duplicated but never matched. I thank you for your careful consideration and I look forward to hearing back from you soon!

Best regards and be well,

Lindsay Carter
Sales Representative
lcarter@greatnortherndocks.com
207-693-3770 EXT: 202



1114 Roosevelt Trail
P.O. Box 1615
Naples, ME 04055 USA
www.greatnortherndocks.com



The prices on this quote are not subject to verbal changes or other arrangements unless approved in writing by Great Northern Docks, Inc. All quotes and agreements are contingent upon strikes, fires, accidents, disease, availability of materials and all other causes beyond our control. Typographical, stenographic & mathematical errors are subject to correction. Conditions not specifically stated herein shall be governed by established trade customs. Terms inconsistent with those stated herein, which appear on purchaser's formal order, will not be binding to the seller. Non-stocking items and special-order items are not refundable. All returned items are subject to a 10% restocking fee. Customer is responsible for freight, both directions on any returned part(s).

GREAT NORTHERN DOCKS, INC.
P.O. Box 1615
1114 Roosevelt Trail
NAPLES, ME 04055
Phone: (207) 693-3770 Fax: (207) 693-3111

QUOTE

Page 1 of 1

QUOTE NO. W-019212

ACCT. NO.: CASHCUST

SOLD TO: Cash Customers

SHIP TO: Town of Norridgewock - Oosoola Park
 Ferry RD
 Norridgewock ME
 UNITED STATES

SALES NO.	CUSTOMER REQ. NUMBER		SHIP VIA	SALES- PERSON	DATE SHIPPED	TERMS	INVOICE DATE
1,995				LC	09/11/2023	1/2 down,bal.B4 del.	09/11/2023
QUANTITY ORDERED	QUANTITY SHIPPED	BACK ORDERED	ITEM NO.	DESCRIPTION		UNIT PRICE	EXTENDED PRICE
1.0	1.0	0.0	9701T-13	Stairs 13-Step w/TF Alum		\$3,759.50	\$3,759.50
2.0	2.0	0.0	9702-13	Stair Rail 13 step		\$873.00	\$1,746.00
1.0	1.0	0.0	9700MID	Mid level supports For Modular Stairs		\$148.00	\$148.00
1.0	1.0	0.0	9700SHR	Shore Mount Kit For Modular Stairs		\$148.00	\$148.00
2.0	2.0	0.0	6105	Pipe 5'3" Galv Pre-Cut		\$47.00	\$94.00
2.0	2.0	0.0	6107	Pipe 7' Galv Pre-Cut		\$62.50	\$125.00
2.0	2.0	0.0	4180	Pipe Foot Adj Alum		\$46.00	\$92.00
4.0	4.0	0.0	2278G	Safety Cap 1-1/2" Gray		\$7.00	\$28.00
Weight 0.00 lbs.							SALES AMOUNT \$6,140.50
Tender Types			Debit Card	\$0.00	TAXABLE TOTAL		\$6,140.50
Cash \$0.00			Alternate Tender	\$0.00	SALES TAX		\$337.73
Check \$0.00			Gift Card	\$0.00	FREIGHT		\$0.00
AR Charge \$0.00			Foreign Currencies	\$0.00	TOTAL		\$6,478.23
Credit Card \$0.00			WebPay	\$0.00	TOTAL DEPOSITS		\$0.00
CC Rebates \$0.00			Thank You		BALANCE REMAINING		\$0.00



Town of Norridgewock – Oosoola Park Dock Proposal
Ferry Road, Norridgewock, Maine
September 8th, 2023

**PROPOSAL FOR STATIONARY SEASONAL DOCK SYSTEM
OPTION 1 DURALITE WITH ALL 6X10'S w/ PERFORATED DECKING**

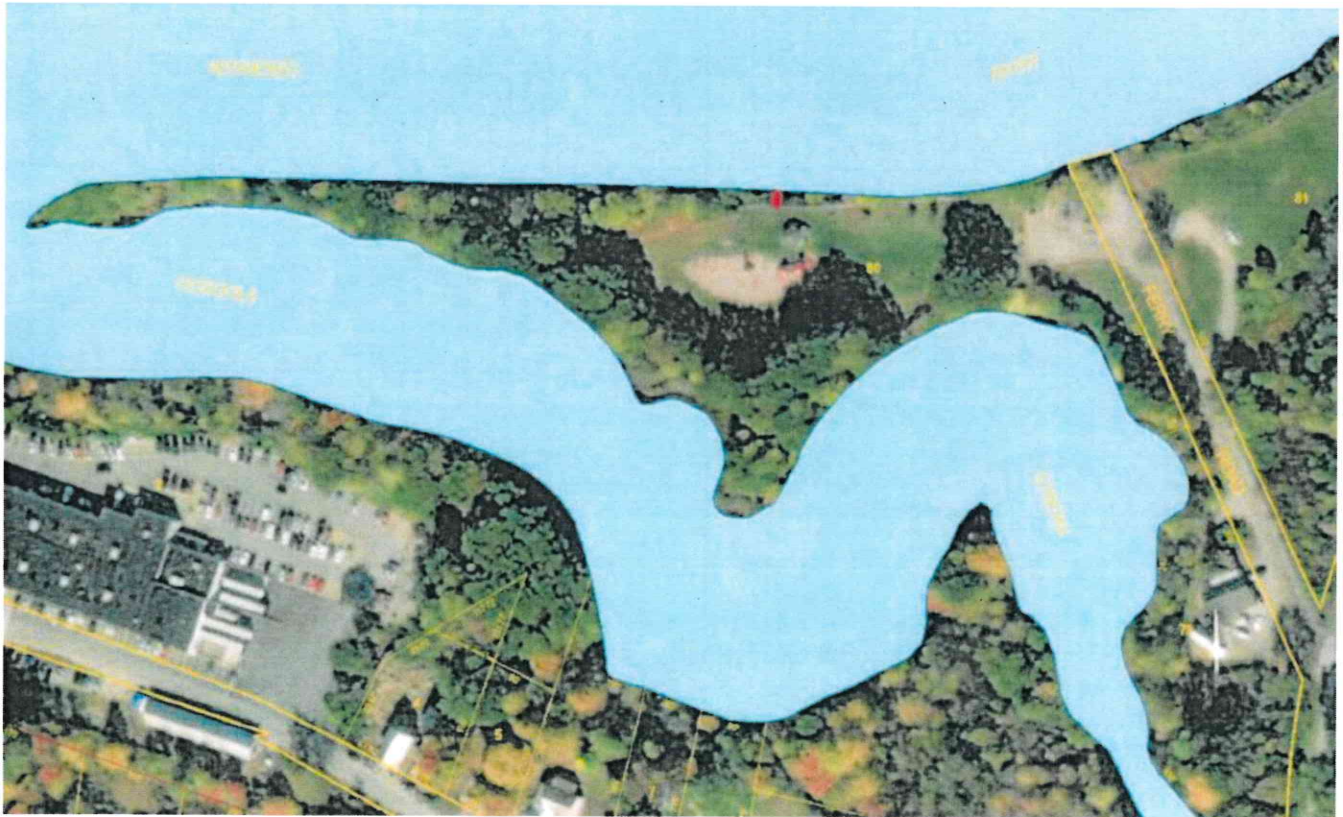

Product sub-total:

\$52,532.50

Total (Including delivery & installation):

\$56,232.50

Notes:

- 1.) Sub-total does not include Maine State Sales Tax (5.5%), delivery or installation.
- 1) Disposal of existing structure is not included.
- 2.) 50% deposit required when proposal accepted & the remaining balance due prior to delivery.
- 3.) The prices on this quote are not subject to verbal changes or other arrangements unless approved in writing by Great Northern Docks, Inc. All quotes and agreements are contingent upon strikes, fires, accidents, disease, availability of materials and all other causes beyond our control. Typographical, stenographic & mathematical errors are subject to correction. Conditions not specifically stated herein shall be governed by established trade customs. Terms inconsistent with those stated herein, which appear on purchaser's formal order, will not be binding to the seller. Non-stocking items and special-order items are not refundable. All returned items are subject to a 10% restocking fee. Customer is responsible for freight, both directions on any returned part(s).

Company Name & Contact Information:

Great Northern Docks
ATTN: Lindsay Carter
207-693-3770 x: 202
lcarter@greatnortherndocks.com

List of Materials / Equipment:

See Attached Product Cut Sheet/ Materials List

Proposed Schedule for Delivery:

April 2024

Price per unit:

Duralite 6x10' \$3,006.50 (Not including pipes, bracing, j-brackets, pipe feet or safety caps)
Duralite 4x16' \$2,705.50 (Not including pipes, bracing, j-brackets, pipe feet or safety caps)
Featherlite 6x10' \$2,566.00 (Not including pipes, bracing, j-brackets, pipe feet or safety caps)
Featherlite 4x10' \$1,715.00 (Not including pipes, bracing, j-brackets, pipe feet or safety caps)

Professional References:

Barry Brewster
City of Saco
Parks Foreman
207-283-3139 X 803
BBrewster@sacomaine.org

Chuck Disciscio
Association Treasurer
Lakefront Landing Condominium Association
603-320-5063
cdisciscio@cbsalesne.com

Proposal provided by:

Quotation By: Lindsay Carter (Sales / Design)
Great Northern Docks, PH: (207) 693-3770,
P.O. Box 1615, 1114 Roosevelt Trail, Naples, ME 04055
lcarter@greatnortherndocks.com

Date: _____

Proposal accepted by:

Date: _____

Option 1 – Duralite Stationary Seasonal Dock System w/ SunWalk Perforated Decking

14 – Duralite 6x10' stationary sections w/ SunWalk perforated decking
Includes all necessary pipe legs, bracing, pipe feet, j-bracket connectors & safety caps for water depths of up to 7.5'.

Sub-total: \$52,532.50

Delivery & installation by Allied Dock Services: \$3,700.00

Total: \$56,232.50

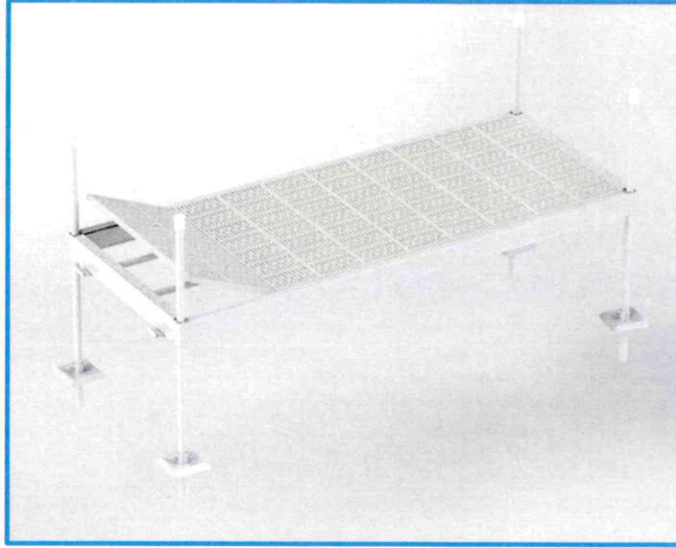

**DuraLITE Stationary Boardwalk Sections w/ SunWalk perforated polypropylene decking
Reinforced w/ fiberglass (SunWalk has 12 year manufacturing warranty, Duralite frame has
Made-in-Maine 15 year warranty)**

Product Features & Materials :

- All welded marine grade tubular aluminum frame Series 6000 w/ 6" tall outside wall (Superior to bolt-together designs & has 15 year warranty)
- Built-in corner sockets w/ infinitely adjustable set screws, (2) per corner
- 45 % Light transmitting decking – environmentally friendly & most anti-slip decking option (12 year Warranty)
- Driven pipe legs in 1-7/8" OD Schedule 40 Galvanized pipe
- Adjustable feet for soft soil/plant surfaces, or optional rock feet
- Interlocking connector – J brackets for easy installation
- Advanced bracing system for heights above 4 feet (Most stable design on the seasonal dock market)
- Bottom accessory track and top groove for easy installation of railings & accessories
- 1 Keyhole anchor plate per section included per customer request
- Includes bracing for up to 7.5'
- AWS certified welders



Town of Norridgewock
Oosoola Park Proposal
Ferry RD, Norridgewock, ME
Drawn by: Lindsay C.
Date: 09/05/2023
Option 1 Duralite with all
6x10's w/ SunWalk
Perforated Decking

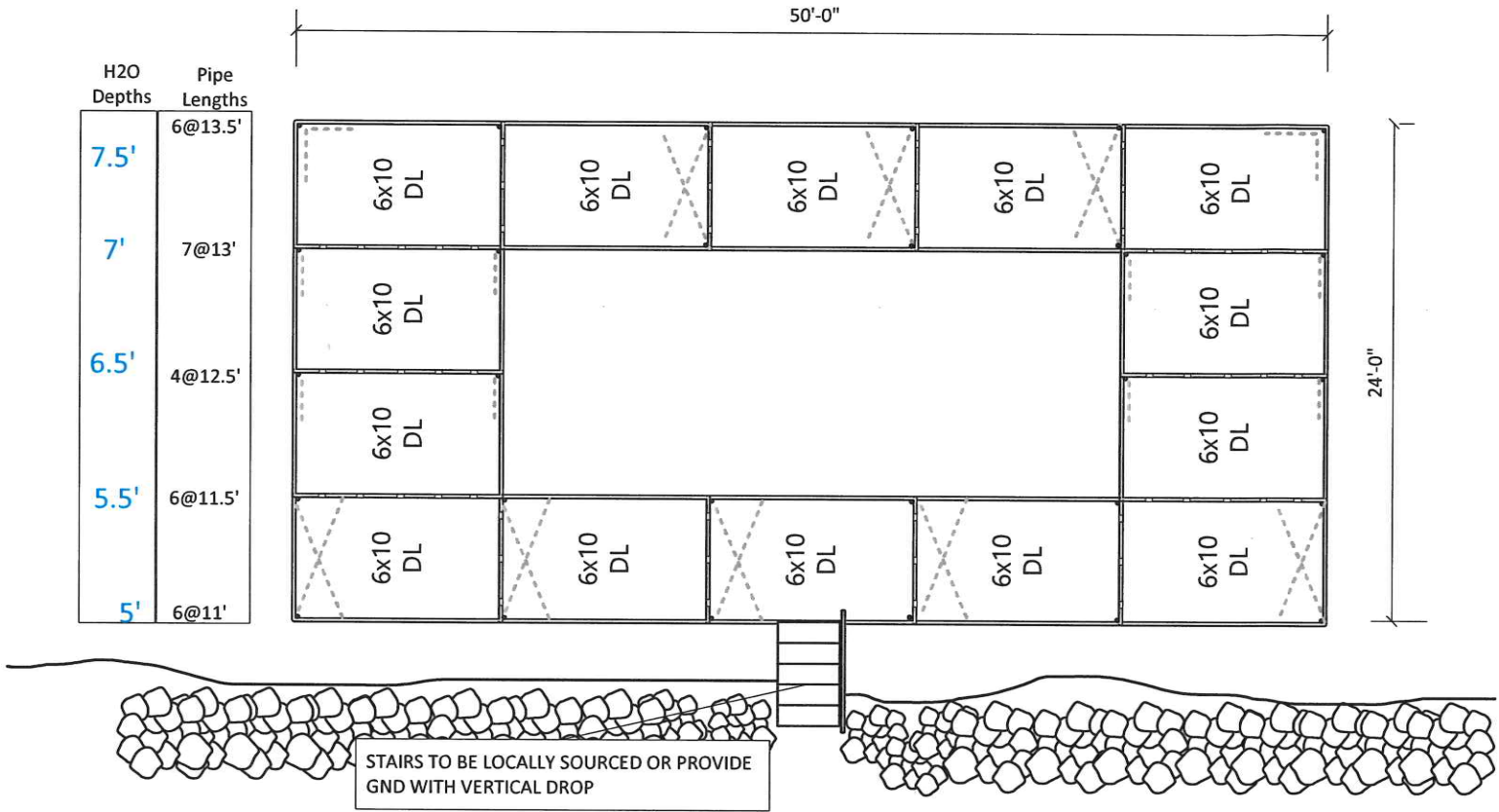



**Town of Norridgewock – Oosoola Park Dock Proposal
Ferry Road, Norridgewock, Maine
September 8th, 2023**

**PROPOSAL FOR STATIONARY SEASONAL DOCK SYSTEM
OPTION 2 DURALITE WITH (4) 4x16's w/ PERFORATED DECKING**

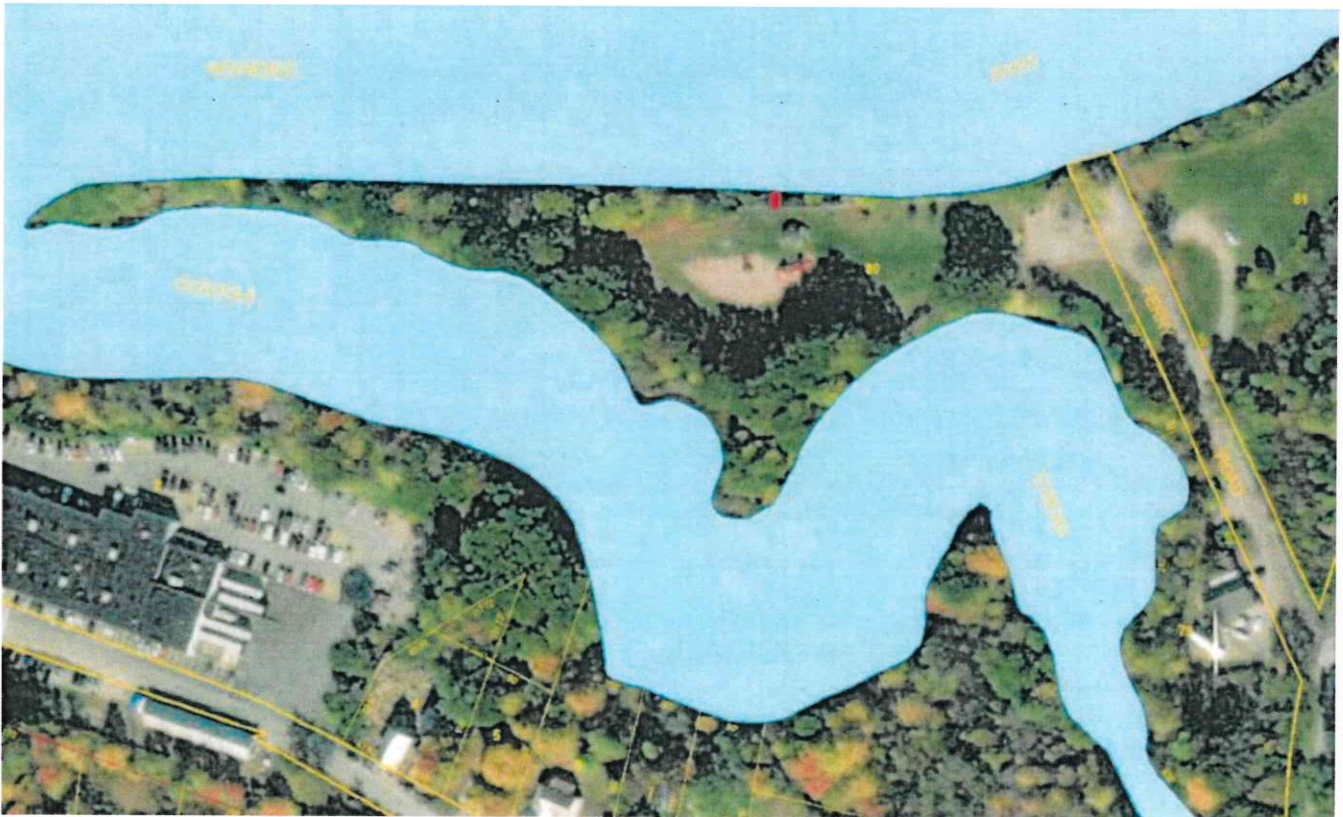

Product sub-total:

\$43,918.00

Product total including delivery & installation:

\$47,618.00

Notes:

- 1.) Sub-total does not include Maine State Sales Tax (5.5%), delivery or installation.
- 1) Disposal of existing structure is not included.
- 2.) 50% deposit required when proposal accepted & the remaining balance due prior to delivery.
- 3.) The prices on this quote are not subject to verbal changes or other arrangements unless approved in writing by Great Northern Docks, Inc. All quotes and agreements are contingent upon strikes, fires, accidents, disease, availability of materials and all other causes beyond our control. Typographical, stenographic & mathematical errors are subject to correction. Conditions not specifically stated herein shall be governed by established trade customs. Terms inconsistent with those stated herein, which appear on purchaser's formal order, will not be binding to the seller. Non-stocking items and special-order items are not refundable. All returned items are subject to a 10% restocking fee. Customer is responsible for freight, both directions on any returned part(s).

Company Name & Contact Information:

Great Northern Docks
ATTN: Lindsay Carter
207-693-3770 x: 202
lcarter@greatnortherndocks.com

List of Materials / Equipment:
See Attached Product Cut Sheet/ Materials List

Proposed Schedule for Delivery:
April 2024

Price per unit:
Duralite 6x10' \$3,006.50 (Not including pipes, bracing, j-brackets, pipe feet or safety caps)
Duralite 4x16' \$2,705.50 (Not including pipes, bracing, j-brackets, pipe feet or safety caps)
Featherlite 6x10' \$2,566.00 (Not including pipes, bracing, j-brackets, pipe feet or safety caps)
Featherlite 4x10' \$1,715.00 (Not including pipes, bracing, j-brackets, pipe feet or safety caps)

Professional References:

Barry Brewster
City of Saco
Parks Foreman
207-283-3139 X 803
BBrewster@sacomaine.org

Chuck Disciscio
Association Treasurer
Lakefront Landing Condominium Association
603-320-5063
cdisciscio@cbsalesne.com

Proposal provided by:

Quotation By: Lindsay Carter (Sales / Design)
Great Northern Docks, PH: (207) 693-3770,
P.O. Box 1615, 1114 Roosevelt Trail, Naples, ME 04055
lcarter@greatnortherndocks.com

Date: _____

Proposal accepted by:

Date: _____

Option 2 – Duralite Stationary Seasonal Dock System w/ SunWalk Perforated Decking

- 8 – Duralite 6x10' stationary sections w/ SunWalk perforated decking
- 4 – Duralite 4x16' stationary sections w/ SunWalk perforated decking
- Includes all necessary pipe legs, bracing, pipe feet, j-bracket connectors & safety caps for water depths of up to 7.5'.

Sub-total: \$43,918.00

Delivery & installation by Allied Dock Services: \$3,700.00

Total: \$47,618.00

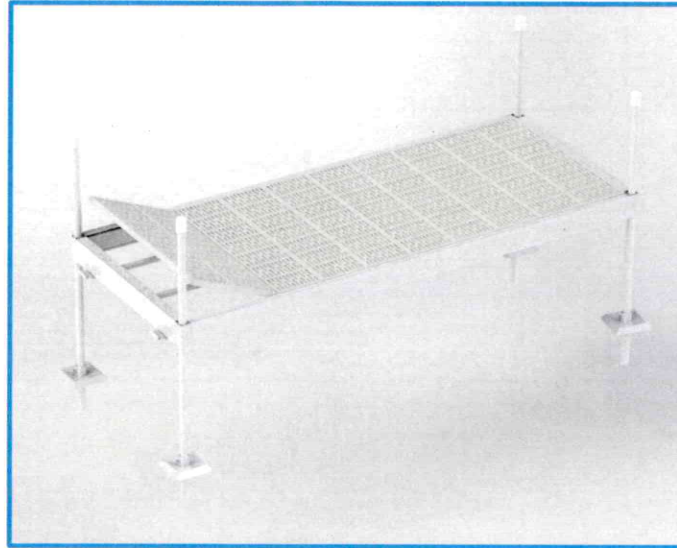

**DuraLITE Stationary Boardwalk Sections w/ SunWalk perforated polypropylene decking
Reinforced w/ fiberglass (SunWalk has 12 year manufacturing warranty, Duralite frame has
Made-in-Maine 15 year warranty)**

Product Features & Materials :

- All welded marine grade tubular aluminum frame Series 6000 w/ 6" tall outside wall (Superior to bolt-together designs & has 15 year warranty)
- Built-in corner sockets w/ infinitely adjustable set screws, (2) per corner
- 45 % Light transmitting decking – environmentally friendly & most anti-slip decking option (12 year Warranty)
- Driven pipe legs in 1-7/8" OD Schedule 40 Galvanized pipe
- Adjustable feet for soft soil/plant surfaces, or optional rock feet
- Interlocking connector – J brackets for easy installation
- Advanced bracing system for heights above 4 feet (Most stable design on the seasonal dock market)
- Bottom accessory track and top groove for easy installation of railings & accessories
- 1 Keyhole anchor plate per section included per customer request
- Includes bracing for up to 7.5'
- AWS certified welders



Town of Norridgewock
Oosoola Park Proposal
Ferry RD, Norridgewock, ME
Drawn by: Lindsay C.
Date: 09/05/2023
Option 2 Duralite w/
SunWalk Perforated Decking
& (4) 4x16's

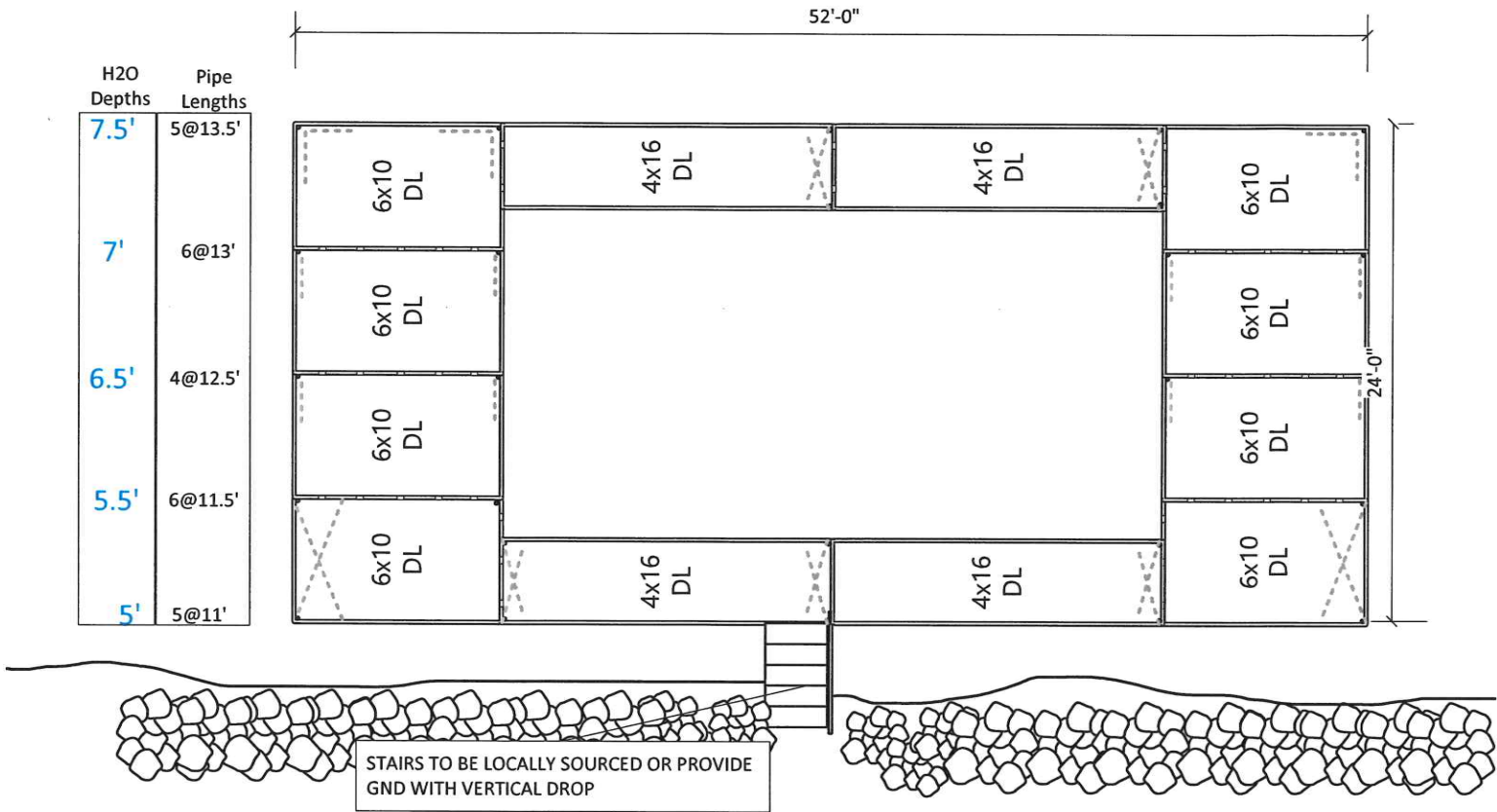



Town of Norridgewock – Oosoola Park Dock Proposal
Ferry Road, Norridgewock, Maine
September 8th, 2023

**PROPOSAL FOR STATIONARY SEASONAL DOCK SYSTEM
OPTION 3 FEATHERLITE WITH (6) 4x10's w/ PERFORATED DECKING**

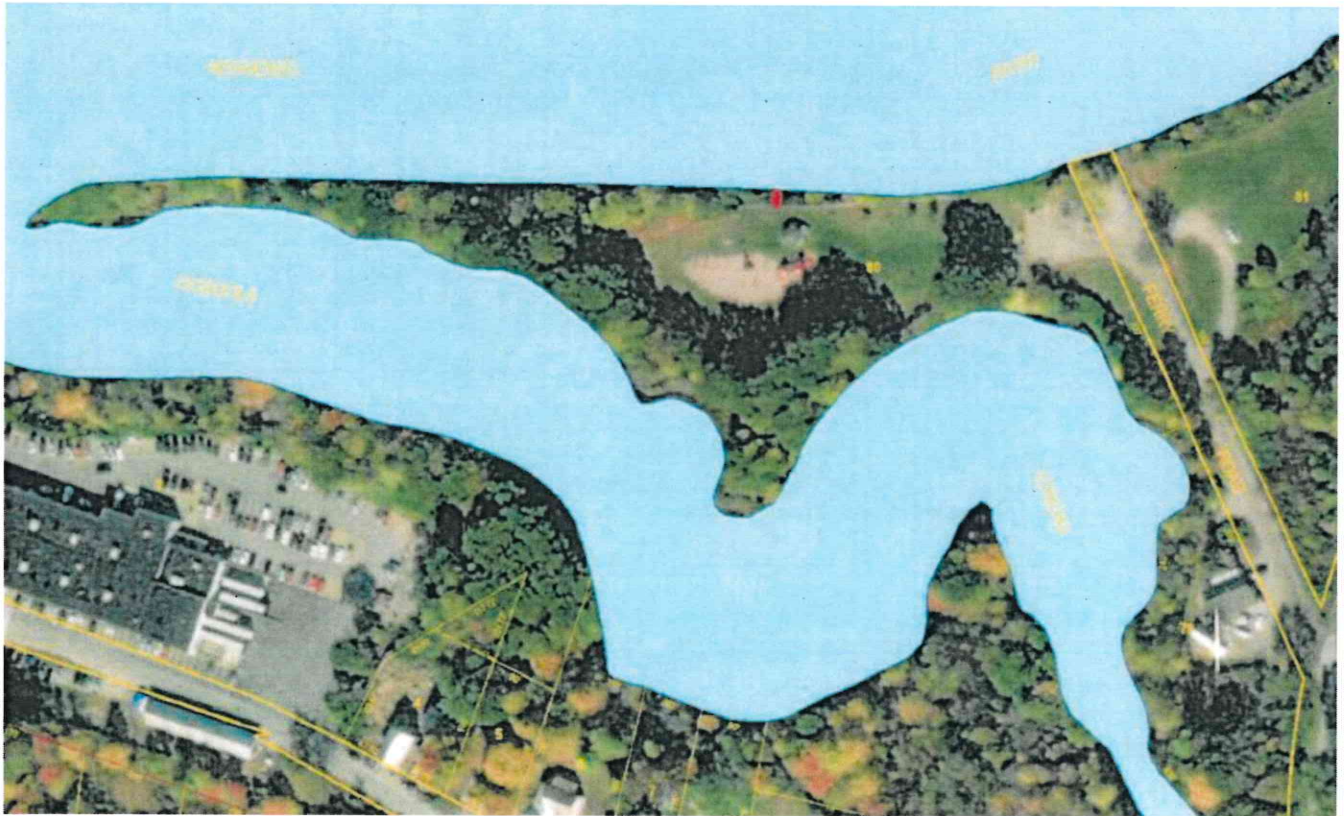

Product sub-total:

\$41,617.50

Product total with install & delivery:

\$45,317.50

Notes:

- 1.) Sub-total does not include Maine State Sales Tax (5.5%), delivery or installation.
- 1) Disposal of existing structure is not included.
- 2.) 50% deposit required when proposal accepted & the remaining balance due prior to delivery.
- 3.) The prices on this quote are not subject to verbal changes or other arrangements unless approved in writing by Great Northern Docks, Inc. All quotes and agreements are contingent upon strikes, fires, accidents, disease, availability of materials and all other causes beyond our control. Typographical, stenographic & mathematical errors are subject to correction. Conditions not specifically stated herein shall be governed by established trade customs. Terms inconsistent with those stated herein, which appear on purchaser's formal order, will not be binding to the seller. Non-stocking items and special-order items are not refundable. All returned items are subject to a 10% restocking fee. Customer is responsible for freight, both directions on any returned part(s).

Company Name & Contact Information:

Great Northern Docks
ATTN: Lindsay Carter
207-693-3770 x: 202
lcarter@greatnortherndocks.com

List of Materials / Equipment:
See Attached Product Cut Sheet/ Materials List

Proposed Schedule for Delivery:
April 2024

Price per unit:
Duralite 6x10' \$3,006.50 (Not including pipes, bracing, j-brackets, pipe feet or safety caps)
Duralite 4x16' \$2,705.50 (Not including pipes, bracing, j-brackets, pipe feet or safety caps)
Featherlite 6x10' \$2,566.00 (Not including pipes, bracing, j-brackets, pipe feet or safety caps)
Featherlite 4x10' \$1,715.00 (Not including pipes, bracing, j-brackets, pipe feet or safety caps)

Professional References:

Barry Brewster
City of Saco
Parks Foreman
207-283-3139 X 803
BBrewster@sacomaine.org

Chuck Disciscio
Association Treasurer
Lakefront Landing Condominium Association
603-320-5063
cdisciscio@cbsalesne.com

Proposal provided by:

Quotation By: Lindsay Carter (Sales / Design)
Great Northern Docks, PH: (207) 693-3770,
P.O. Box 1615, 1114 Roosevelt Trail, Naples, ME 04055
lcarter@greatnortherndocks.com

Date: _____

Proposal accepted by:

Date: _____

Option 3 – Featherlite Stationary Seasonal Dock System w/ SunWalk Perforated Decking

8 – Featherlite 6x10' stationary sections w/ SunWalk perforated decking

6 – Featherlite 4x10' stationary sections w/ SunWalk perforated decking

Includes all necessary pipe legs, bracing, pipe feet, j-bracket connectors & safety caps for water depths of up to 7.5'.

Sub-total: \$41,617.50

Delivery & installation by Allied Dock Services: \$3,700.00

Total: \$45,317.50

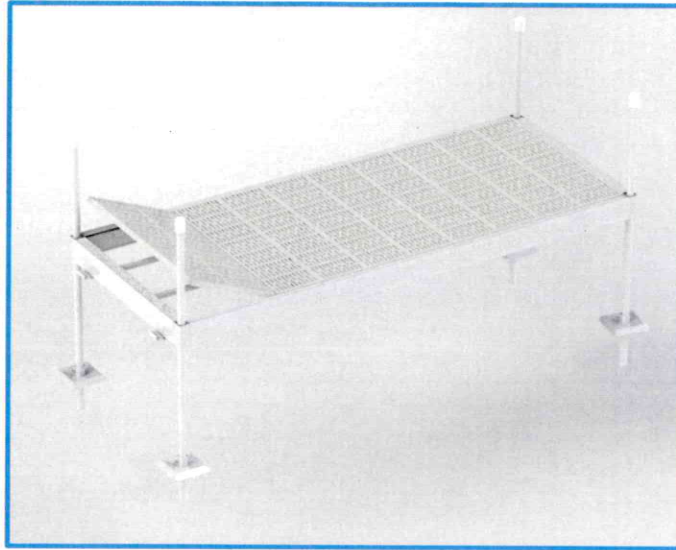

**DuraLITE Stationary Boardwalk Sections w/ SunWalk perforated polypropylene decking
Reinforced w/ fiberglass (SunWalk has 12 year manufacturing warranty, Duralite frame has
Made-in-Maine 15 year warranty)**

Product Features & Materials :

- All welded marine grade tubular aluminum frame Series 6000 w/ 6" tall outside wall (Superior to bolt-together designs & has 15 year warranty)
- Built-in corner sockets w/ infinitely adjustable set screws, (2) per corner
- 45 % Light transmitting decking – environmentally friendly & most anti-slip decking option (12 year Warranty)
- Driven pipe legs in 1-7/8" OD Schedule 40 Galvanized pipe
- Adjustable feet for soft soil/plant surfaces, or optional rock feet
- Interlocking connector – J brackets for easy installation
- Advanced bracing system for heights above 4 feet (Most stable design on the seasonal dock market)
- Bottom accessory track and top groove for easy installation of railings & accessories
- 1 Keyhole anchor plate per section included per customer request
- Includes bracing for up to 7.5'
- AWS certified welders



Town of Norridgewock
Oosoola Park Proposal
Ferry RD, Norridgewock, ME
Drawn by: Lindsay C.
Date: 09/05/2023
Option 3 Featherlite w/
SunWalk Perforated Decking
& (6) 4x10's

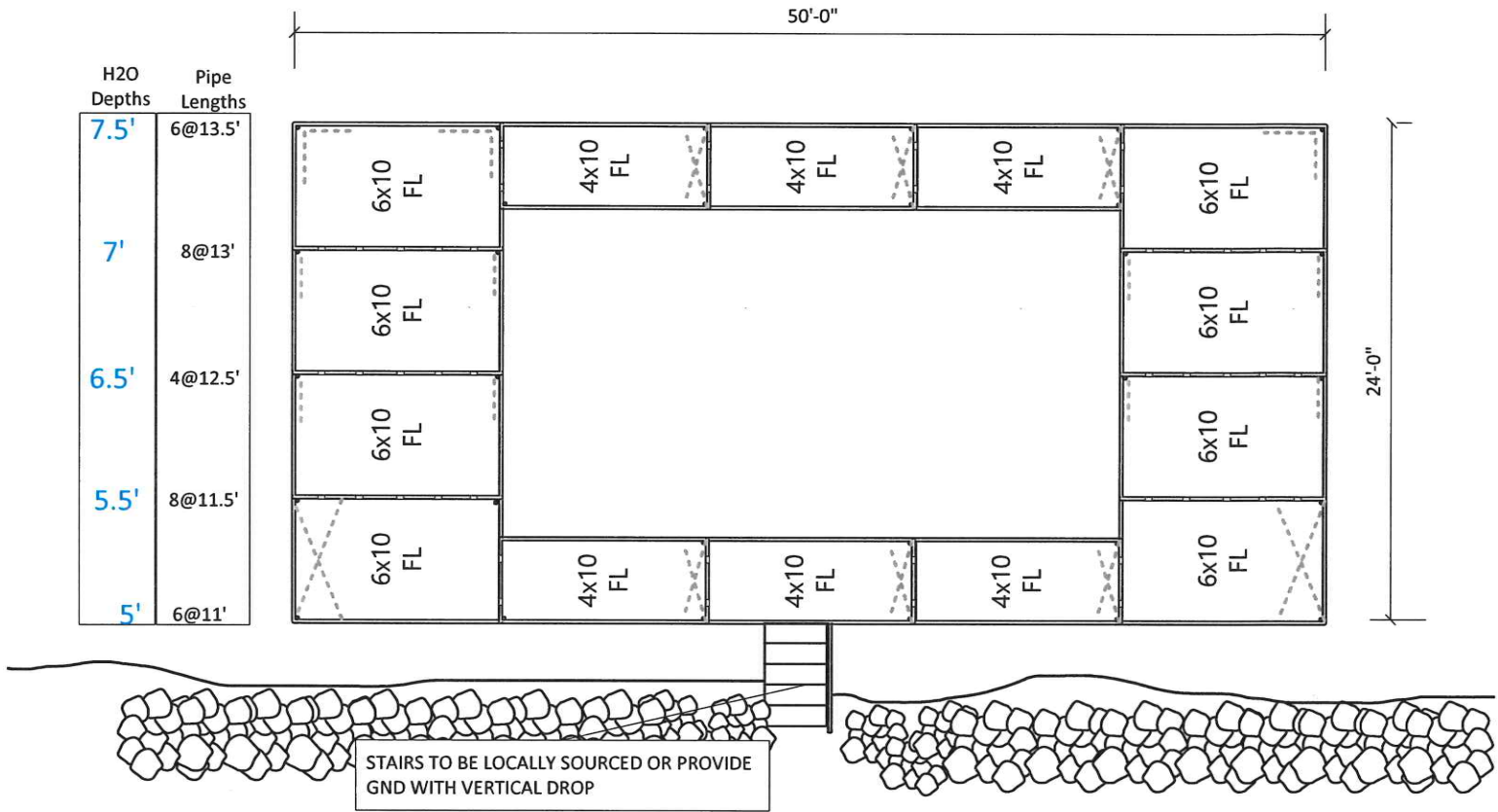



Town of Norridgewock – Oosoola Park Dock Proposal
Ferry Road, Norridgewock, Maine
September 8th, 2023

**PROPOSAL FOR STATIONARY SEASONAL DOCK SYSTEM
OPTION 4 FEATHERLITE WITH ALL 6X10'S w/ PERFORATED DECKING**

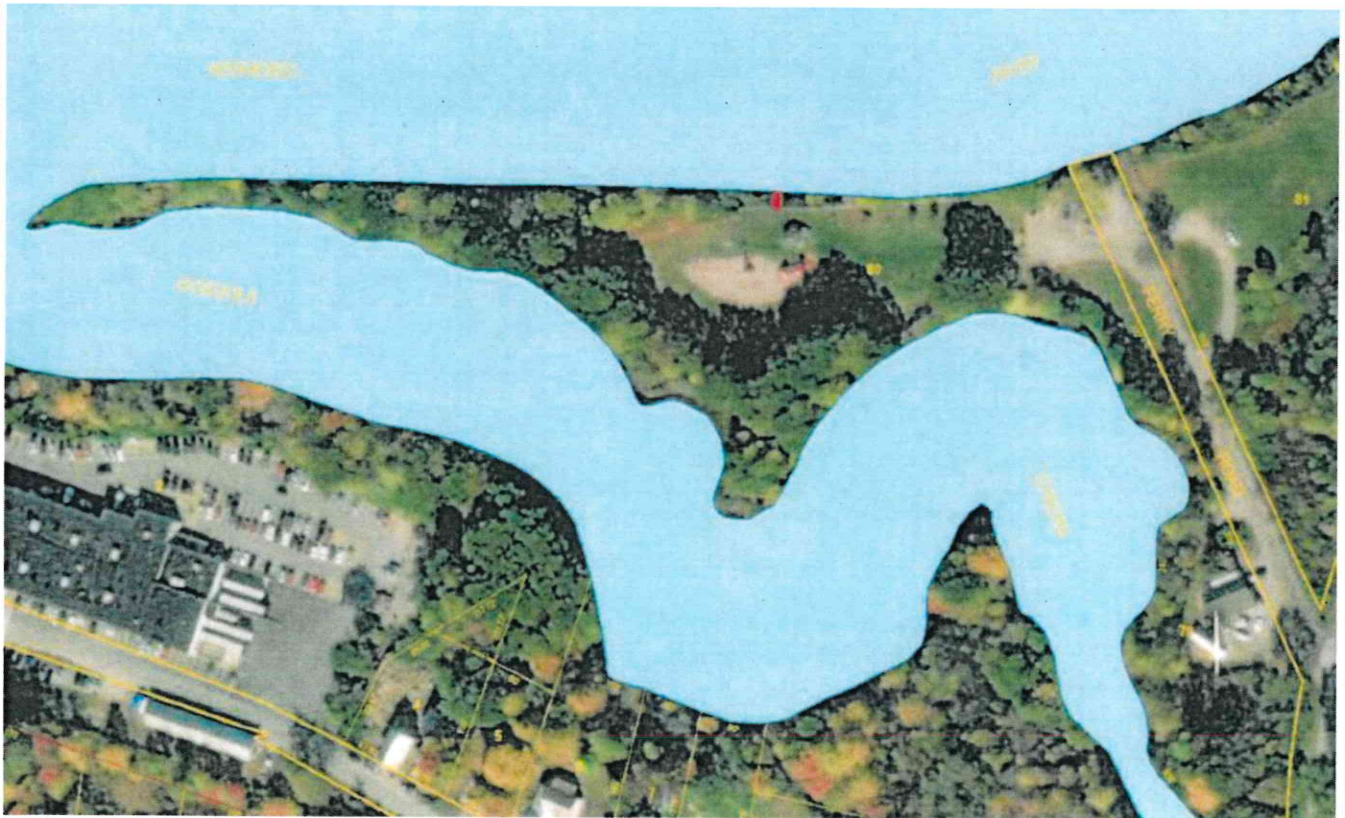

Product sub-total:

\$46,382.00

Product total with delivery & install:

\$50,082.00

Notes:

- 1.) Sub-total does not include Maine State Sales Tax (5.5%), delivery or installation.
- 1) Disposal of existing structure is not included.
- 2.) 50% deposit required when proposal accepted & the remaining balance due prior to delivery.
- 3.) The prices on this quote are not subject to verbal changes or other arrangements unless approved in writing by Great Northern Docks, Inc. All quotes and agreements are contingent upon strikes, fires, accidents, disease, availability of materials and all other causes beyond our control. Typographical, stenographic & mathematical errors are subject to correction. Conditions not specifically stated herein shall be governed by established trade customs. Terms inconsistent with those stated herein, which appear on purchaser's formal order, will not be binding to the seller. Non-stocking items and special-order items are not refundable. All returned items are subject to a 10% restocking fee. Customer is responsible for freight, both directions on any returned part(s).

Company Name & Contact Information:

Great Northern Docks
ATTN: Lindsay Carter
207-693-3770 x: 202
lcarter@greatnortherndocks.com

List of Materials / Equipment:
See Attached Product Cut Sheet/ Materials List

Proposed Schedule for Delivery:
April 2024

Price per unit:
Duralite 6x10' \$3,006.50 (Not including pipes, bracing, j-brackets, pipe feet or safety caps)
Duralite 4x16' \$2,705.50 (Not including pipes, bracing, j-brackets, pipe feet or safety caps)
Featherlite 6x10' \$2,566.00 (Not including pipes, bracing, j-brackets, pipe feet or safety caps)
Featherlite 4x10' \$1,715.00 (Not including pipes, bracing, j-brackets, pipe feet or safety caps)

Professional References:

Barry Brewster
City of Saco
Parks Foreman
207-283-3139 X 803
BBrewster@sacomaine.org

Chuck Disciscio
Association Treasurer
Lakefront Landing Condominium Association
603-320-5063
cdisciscio@cbsalesne.com

Proposal provided by:

Quotation By: Lindsay Carter (Sales / Design)
Great Northern Docks, PH: (207) 693-3770,
P.O. Box 1615, 1114 Roosevelt Trail, Naples, ME 04055
lcarter@greatnortherndocks.com

Date: _____

Proposal accepted by:

Date: _____

Option 4 – Featherlite Stationary Seasonal Dock System w/ SunWalk Perforated Decking

14 – Featherlite 6x10' stationary sections w/ SunWalk perforated decking
Includes all necessary pipe legs, bracing, pipe feet, j-bracket connectors & safety caps for water depths of up to 7.5'.

Sub-total: \$46,382.00

Delivery & installation by Allied Dock Services: \$3,700.00

Total: \$50,082.00

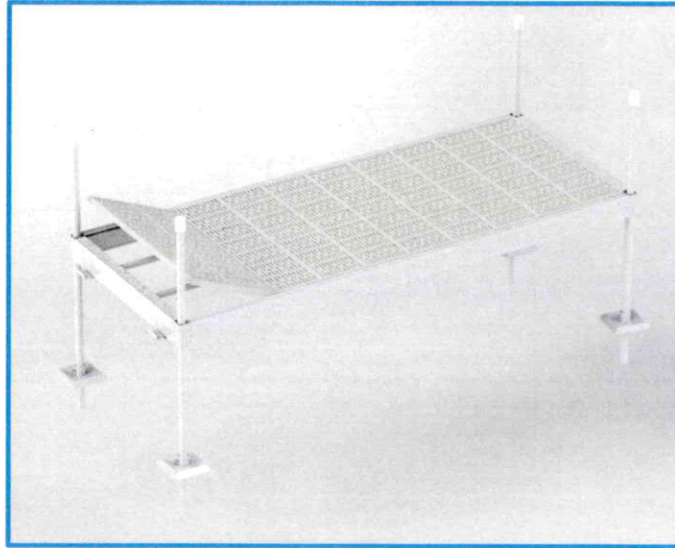

**DuraLITE Stationary Boardwalk Sections w/ SunWalk perforated polypropylene decking
Reinforced w/ fiberglass (SunWalk has 12 year manufacturing warranty, Duralite frame has
Made-in-Maine 15 year warranty)**

Product Features & Materials :

- All welded marine grade tubular aluminum frame Series 6000 w/ 6" tall outside wall (Superior to bolt-together designs & has 15 year warranty)
- Built-in corner sockets w/ infinitely adjustable set screws, (2) per corner
- 45 % Light transmitting decking – environmentally friendly & most anti-slip decking option (12 year Warranty)
- Driven pipe legs in 1-7/8" OD Schedule 40 Galvanized pipe
- Adjustable feet for soft soil/plant surfaces, or optional rock feet
- Interlocking connector – J brackets for easy installation
- Advanced bracing system for heights above 4 feet (Most stable design on the seasonal dock market)
- Bottom accessory track and top groove for easy installation of railings & accessories
- 1 Keyhole anchor plate per section included per customer request
- Includes bracing for up to 7.5'
- AWS certified welders



Town of Norridgewock
Oosoola Park Proposal
Ferry RD, Norridgewock, ME
Drawn by: Lindsay C.
Date: 09/05/2023
Option 4 Featherlite w/
SunWalk Perforated Decking
& All 6x10's

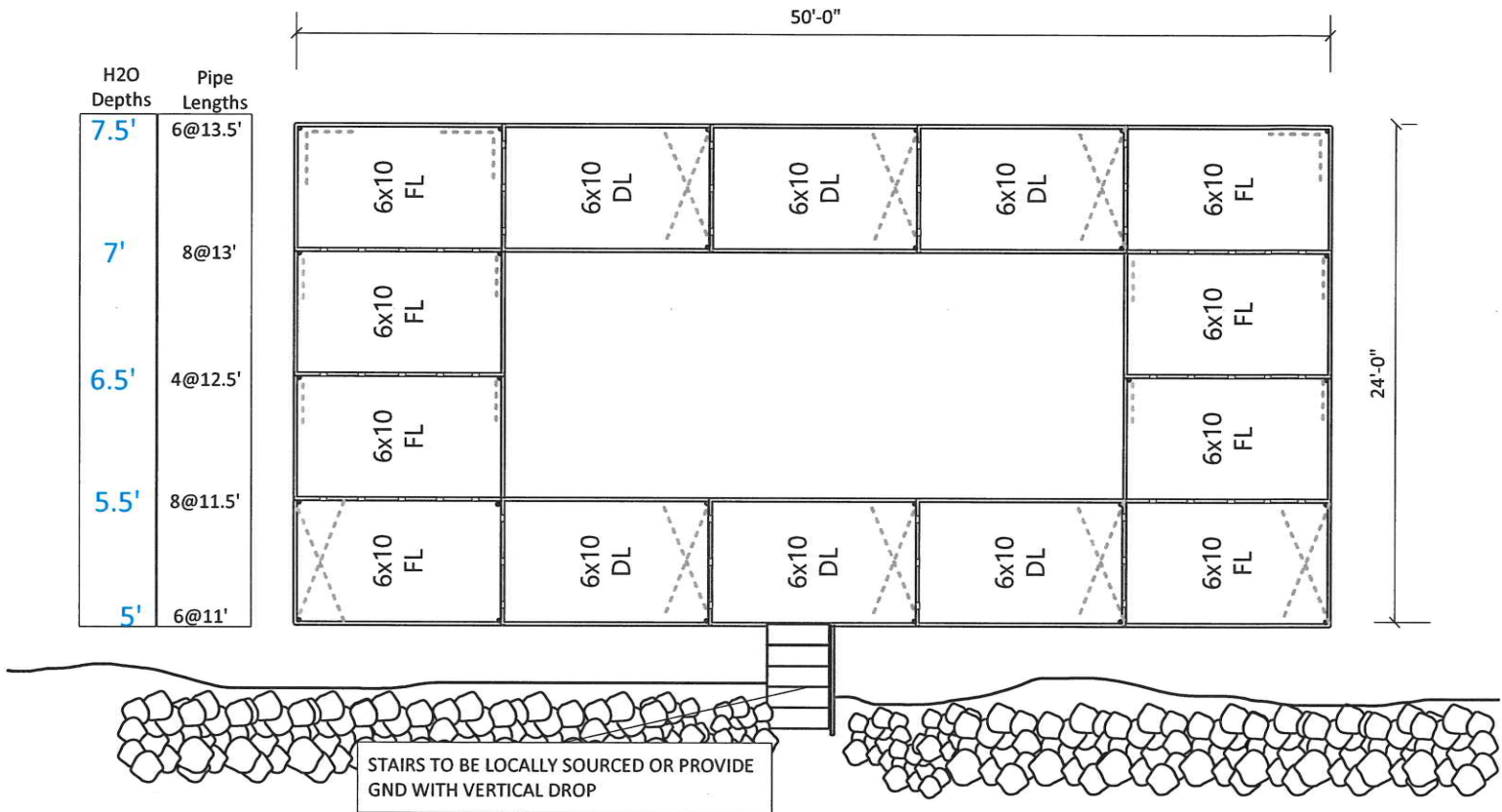

Proposal for the purchase of a new dock system to be placed at
Oosoola Park, in the Kennebec River

Norridgewock, Maine

September 14, 2023

Chesterfield Associates Inc. bids a lump sum of \$154,588.00 (One Hundred Fifty Four Thousand Five Hundred Eighty-Eight Dollars and Zero Cents) to provide and install a set of 4' wide aluminum stairs to access docks and (16) 8' x 6' cedar decked fixed aluminum dock sections with pad eye/hook points under the center of each dock, arranged per drawing of RFP.

We would provide insurance upon award and coordinate delivery & install with the town.



E. Davies Allan, President

Equipment for Install:

Tractor Trailer
20 ton Hydraulic Crane
26' workboat

Proposal for the purchase of a new dock system to be placed at
Oosoola Park, in the Kennebec River
Norridgewock, Maine
September 14, 2023
Continued

Proposed Max Dock Stairs (20-30 day lead time) :



TYP

- **48" Step Width**
- • 12 Anti-Slip Steps with Aluminum Bullnose
- • **Middle Step of Legs and X-Brace Included**
- • Aluminum, Stainless and Titan Decking construction
- • **Handrails for both sides included** on 7 - 12 step models
- • Stainless steel fastening hardware
- • Step surface available in two colors Tan and Gray
- • 18" Adjustable Front Legs
- • Upper and Lower Handrail Bar

Proposal for the purchase of a new dock system to be placed at
Oosoola Park, in the Kennebec River
Norridgewock, Maine
September 14, 2023
Continued

Proposed Fixed Aluminum 6' x 8' docks (5-8 week lead time):



TYP

RS7 KEY FEATURES

- **HEAVY DUTY**, Standing Configurability
- All Welded Frame Aluminum Design
- Configuration options for Freestanding
- **Removable Decking**, for easier install and removal
- Commercial Strength **6.75"** Tall, Fully welded Side Rails
- Easy to Customize - **Quick Connect Accessory System**
- Stainless Steel & Brass Fasteners
- Decking Material Options

Proposal for the purchase of a new dock system to be placed at
Oosoola Park, in the Kennebec River
Norridgewock, Maine
September 14,2023
Continued

Professional References:

Jesse Helms, PE
Calderwood Engineering
3 Industrial Park
Suite 2
Brunswick, ME 04011
207.737.2007
Jesse@calderwoodengineering.com

Duncan Mellor, PE
Civil Works New England, Haight Engineering LLC
181 Watson Rd.
Dover, NH 03821
603.749.0443
dmellor@civilworksne.com

Prospective proposers are encouraged to notify the Town Manager via e-mail of one's interest in submitting a quotation and/or receiving information updates in the event addendums are issued. An e-mail distribution list will be developed to communicate with prospective proposers most efficiently.

Proposal Submittal Instructions

Proposals may be mailed, hand-delivered, or e-mailed to:

Town of Norridgewock
Richard LaBelle, Town Manager
PO Box 7 | 16 Perkins St.
Norridgewock, ME 04957
rlabelle@norridgewock.gov

Closing of Bids

All proposals must be received by 2:00 p.m., Thursday, September 14, 2023.

Review and Final Selection

An internal review of vendor selection shall begin upon bid closing. It will be sent to the Select Board for consideration during its regularly scheduled meeting on Wednesday, September 16, 2023, at 6:00 p.m. The final selection may be made during this meeting. In the event that a final selection is not made on September 16, 2023, all vendors submitting quotations will be notified, and meeting notices will be available approximately four (4) days before the actual meeting date.

Terms and Conditions

1. The Town of Norridgewock intends to award this contract to the individual or firm that provides the lowest responsible and responsive bid that the Select Board deems to be in the best interests of the Town. The Town of Norridgewock reserves the right to accept or reject any or all bids and to waive any formality or technicality in the submissions.
2. The Town of Norridgewock reserves the right to re-issue any requests for proposals.
3. Clarification of Proposals: The Town reserves the right to obtain clarification of any point in a vendor's proposal or obtain additional information.
4. The Town reserves the right to disqualify any proposal upon evidence of collusion, intent to defraud, or any other illegal practice on the part of the vendor.
5. Upon the selection of a finalist vendor, the Town by its proper officials, employees, or agents shall attempt to negotiate and reach a final agreement with this vendor. If the Town, for any reason, is unable to reach a final agreement with this vendor, the Town reserves the right to attempt to reject such vendor and negotiate a final agreement with the vendor who has the next most viable proposal or bid. The Town may also elect to reject all proposals and re-issue a request for proposal.
6. Actual delivery of the docks will be mutually agreed upon by the Proposer and Town at the time of contract signing.





COMPANY OVERVIEW

Since 1968

Chesterfield Associates

-Spirit -- Tenacity -- Determination-

123 West Shore Road
Westport Island, ME 04578
Phone: 207-882-5400
Fax: 207-882-9308

e-mail: boathouse@gwi.net

website: www.ca-inc.net

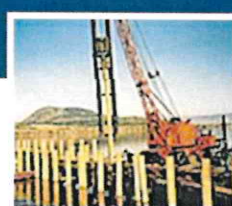
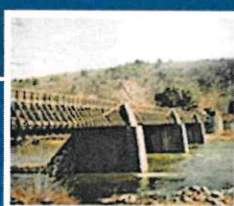
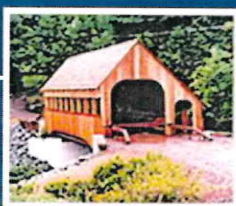

Proprietary and Confidential
© 2008 Chesterfield Associates, Inc.
All Rights Reserved

Chesterfield Associates, Inc. - 45 Years in Marine Construction and Engineering

For fifty years, since its founding in 1968, Chesterfield Associates, Inc. has provided marine construction, engineering and related services all along the eastern seaboard from Virginia to Maine for a wide range of customers including the Federal, State and local government agencies, private companies and individuals.

The Company is primarily a marine contractor providing a large array of services in excavation, drainage and crane services. Chesterfield Associates, Inc. does work in the following NAICS codes:

NAICS Code: 237310 - Highway, Street, and Bridge Construction

NAICS Code: 237990 - Other Heavy and Civil Engineering Construction

Some of the company's prominent clients include the U.S. Coast Guard, the National Park Service, and many other Mid-Atlantic States, counties and municipalities in addition to a large base of private clients. At its headquarters facility in Westport Island, Maine, Chesterfield maintains its fleet of heavy equipment, marine vessels and construction vehicles in its own facilities that cover 40 acres of industrial space.

Since 1985, Chesterfield has completed over 575 projects that range in size from \$20,000 to as much as \$15M, with aggregate revenues of those projects totaling over \$100M. In addition to those projects, the company has done many smaller ones as well. Doing between \$10M and \$12M in business each year, the Company is one of the largest non-union contractors in Maine and employs some forty five people.

The Company has received many awards for quality of its workmanship and takes great pride in delivering projects on time and within budget. Chesterfield is well staffed with professionals in many disciplines and has the requisite resources, skill and experience to handle a wide variety of projects.

Wide Range of Marine Construction and Engineering Services

Chesterfield Associates, Inc. is proud of its ability to undertake technically difficult projects normally outside of the capacity of other construction companies. The company has the kind of experience and creativity to find effective and cost efficient solutions for the most complex projects across a wide range of marine related projects. The company consistently works with Design Engineers to find more cost-effective ways to achieve superior results for its clients.

New Construction Projects and Historical Preservations

The company is experienced in new construction projects, as well as historical renovation projects, such as bridges and lighthouses, satisfying



requirements to bring those structures up to modern safety and operational standards, while retaining the historical look of these important landmarks.

Marine Construction and Dock Building



Marine Construction and Dock Building is the main thrust of the Company and its reputation in the industry with clients and engineers is second to none.

Expertise in this area ranges from planning and construction of complete residential and commercial docks, piers, various types of bulkhead structures, and the rehabilitation of existing structures.

Chesterfield's diverse capabilities span the construction of small residential fixed piers of less than 100 square feet to large commercial and municipal projects that can be several hundred feet long and thousands of square feet in size.

The material for these structures varies widely as well, ranging from pressure treated timber and pilings to composite materials as well as beautiful and durable tropical hardwoods.

Hardware for these structures is generally hot-dipped galvanized or stainless steel. Construction materials range from steel to composite to vinyl to wood and even to concrete. Whatever the condition and the environmental and regulatory guidelines may dictate, Chesterfield has a solution for any project.



The Company also has the ability to access projects in many ways, whether by land or water, including lakes and ponds.

Chesterfield owns several sectional barges which can be transported over land by truck and assembled in a pond or lake that may not be accessible by navigable waterways. The Company also has a large fleet of off-road vehicles and equipment allowing access by beach when necessary.



When structures are still in serviceable condition, Chesterfield has the ability to rehabilitate, upgrade or repair structures which in many cases can save a significant amount of money.

Site Development and Excavation



Chesterfield can perform demolition with a wide variety of equipment and recycles where possible. The company can handle all phases of any project, from permitting and utility disconnects, to final clean up.

Chesterfield can also recommend environmental remediation contractors with whom it has worked when specific projects requires those services.

The company's excavating services are top notch with extensive equipment that is well-maintained and ready-to-go and is operated by skilled and licensed operators. The Company's operators are aware of any underground utilities such as wiring, natural gas, water, sewers and drains. Chesterfield is well-equipped to serve any excavating needs and has a wide variety of specialized equipment that can accommodate projects requiring considerable digging depths or special applications such as slope stabilization along Long Island's vast coastline.



Marine Salvage and Marine Transportation



Chesterfield Associates, Inc. owns a fleet of floating equipment to service any marine salvage or marine transportation needs. This equipment includes push boats, mechanized landing crafts, cranes and sectional barges, which are owned by the company and can easily be transported over land for remote location work. The wide

variety of marine vessels and equipment is utilized for many services ranging from salvaging marine vessels to hosting fireworks shows, to accessing remote areas with equipment, men and material to accomplish any task.

For over 40 years, the company's wide variety of equipment has been utilized to accomplish challenging off-shore projects for both the US Navy and the US Coast Guard.

The Coast Guard remains one of Chesterfield's top clients. They enjoy the rapport that has developed over the many years.

Bridge Building

Chesterfield Associates has completed a variety of bridge projects from residential to multi-lane highway and has completed a number of challenging projects that are outside the capabilities of most construction firms.

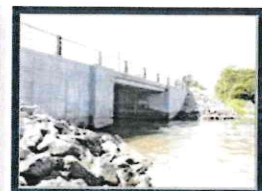

The Company's experience in bridge building extends to historic preservation and rehabilitation as well, with covered bridges and canal aqueducts as an example.

Pile Driving

Chesterfield Associates, Inc. specializes in Timber Piles, Steel Piles, Helical Piles and Steel Sheet Piling spanning all types of installation and shoring methods for military, government, residential, commercial or municipal projects.

Chesterfield is factory certified by A.B. Chance for helical pier and tieback installation.



Chesterfield can advise, design, and install all types of pilings using both traditional and novel methods and procedures. Over its 45 years of existence, the company has driven and tested thousands of pilings safely, economically and environmentally correct.

Using exceptionally high quality machinery and experienced personnel, projects are completed accurately, safely, within budget and on schedule.

Management and Staffing

Lead by a deeply experienced 4 person management team with a combined 115 years of experience, Chesterfield's highly qualified management team brings decades of experience to all projects to ensure a high quality project, completed safely, on schedule and in budget.

Chesterfield Associates, Inc. employs approximately 40 additional personnel made up of supervisors, equipment operators and construction personnel. The majority of the supervisors have been with the company for at least 15 years, and over 95% of the field personnel have been with the company for over eight years. All of the employees of Chesterfield are well trained, dedicated to safety and quality and are highly skilled. Among the staff of Chesterfield are two employees who hold New York Welding Certifications, employees who hold boating Captains' Licenses, Crane Operating Licenses, and various Commercial Diving Licenses.

Safety is of primary concern for Chesterfield, and all field personnel have received certificates for the 10-hour OSHA training program. As a result of the company's comprehensive accident prevention policy, extensive training and focus on safety, Chesterfield has achieved an excellent safety record.

Chairman and Founder - E. Davies Allan

Mr. Allan founded Chesterfield Associates, Inc. in 1968 and has led the company for the past 40 years.

Mr. Allan started his career in 1962, spending 5 years as a technical writer for Markem Machine in Keene, NH prior to starting Chesterfield Associates.

Mr. Allan holds a degree in Civil Engineering from the University of Pennsylvania, a Class 'A' Commercial Drivers License and an Unlimited Crane License.

General Manager - Jeffrey E. Grube

Mr. Grube joined the company in 1979 and had over twenty years of hands-on experience with all phases of quality bridge renovations and construction of large projects before becoming part of the management team at Chesterfield. Mr Grube has complete knowledge of construction and trade requirements including architectural engineering, surveying, heavy equipment operation, excavation and demolition. Mr. Grube is skilled in all construction phases and is known for excellent interpersonal communication skills that allow the development of strong rapport with individuals at every level.

Mr. Grube has completed the 10-hour Occupational Safety & Health Training Course in Construction Safety and Health and holds a Cable Crane Certification of Competence and a Class 'A' Commercial Drivers License.

Vice President, Project Supervisor - Alexander T. Allan

Mr. Allan joined the company in 1983 and supervises the wide range of marine projects done by the company. Mr. Allan tackles some of the Company's most complex and challenging tasks and is known throughout the Company's client base to be safe, efficient and cost conscious by presenting project owners with innovative and cost effective design ideas.

Mr. Allan holds a Class 'A' Commercial Drivers License, an Unlimited Crane License and is a licensed diver.

Corporate Vice President & Field Operations Coordinator - Seth Allan

Mr. Allan joined the company in 1980 and was appointed a Corporate Vice President in 1996. His responsibilities include estimating, project management and directing the entire company's field operations, including dredging, pile driving, marine services, excavation, septic work and miscellaneous projects. Mr. Allan is skilled in preventative maintenance activities, job scheduling, inventory control, and contractor supervision. He is a recognized expert in reading and interpreting blueprints and schematics, and has specialized knowledge of marine services.

Mr. Allan holds a Class 'A' Commercial Drivers License and an Unlimited Crane License.

A Long List of Satisfied Customers and Awards

A partial list of Government Customers includes:

Federal Government

- United States Department of the Interior - National Park Service (Babylon, NY; Staten Island, NY; Westover, MA;
- United States Department of Homeland Security
- United States Coast Guard - Providence, RI; Cleveland, OH; Norfolk, VA
- United States Department of Defense, United States Navy
- United States Department of Defense, United States Air Force Air National Guard
- United States Department of Defense, United States Army Corps. Of Engineers
- United States Department of Transportation
- United States Department of Agriculture

State of Maine

- State of Maine Department of Transportation
- State of Maine Bureau of General Services

Towns & Counties within the State of Maine

- | | |
|---------------------------|-------------------------|
| ➤ Town of Sheepscot | Town of Litchfield |
| ➤ Town of Monhegan | Town of Boothbay Harbor |
| ➤ Town of Cranberry Isle | City of Bath |
| ➤ Town of Westport Island | Town of Monmouth |
| ➤ Town of Phippsburg | Town of Unity |
| ➤ Town of Moosehead | Piscataquis County |
| ➤ Town of Islesboro | |
| ➤ Town of Bristol | |
| ➤ Town of Yarmouth | |
| ➤ City of Brunswick | |

State of New Hampshire

- New Hampshire Department of Transportation
- Town of Wolfeboro

State of Vermont

- Vermont Department of Transportation

Private Entities include

- | | |
|------------------------------|------------------------------------|
| ➤ Atlantic Salmon Federation | Lake Champlain Transportation |
| ➤ Maine Maritime Museum | Kennebec Estuary Land Preservation |
| ➤ Maine's First Ship | |

A partial list of prominent historical restoration projects includes:

- Restored three historic bridges in Pennsylvania, New Hampshire and Maine including the Roebling Bridge in Pennsylvania, the Windsor Cornish Bridge in New Hampshire, and the Lowe's Bridge in Guilford Maine.
- Successfully restored, electrically, esthetically, and structurally several lighthouses for the United States Coast Guard.

Awards

- Accreditations from the US Department of the Interior for the rehabilitation of the Roebling Bridge in Lackawacken, PA
- Presidential Award for Design Excellence for the Roebling Bridge Project
- Accreditations from the Village of Saltaire for the reconstruction of the piers on the barrier beach of Long Island.



Over 70 pieces of heavy equipment, 14 Marine Vessels and 40 acres of facilities

Chesterfield Associates, Inc. is unique in the number and wide range of heavy equipment, marine vessels and vehicles it owns. This allows the company to put the appropriate equipment to work on a project to get that project done quickly and efficiently, saving the customer time and money.

Many other similar companies must rent equipment, and to keep costs down, those companies will often use equipment that has limited capacity to get the job done quickly, resulting in higher costs and longer project durations.

The philosophy of Chesterfield is to deploy the right equipment, of the right size to get the job done.

Heavy Equipment

Chesterfield has over 70 pieces of heavy equipment worth over \$3M. These pieces range from cranes of all types, to loaders, backhoes, bulldozers, boom trucks, excavating equipment, forklifts, pile-driving hammers and amphibious trucks



Along with the list of more common construction equipment listed above, Chesterfield has an ever-increasing array of specialized tools and equipment which lends itself well to its diverse workload.

This impressive set of equipment gives Chesterfield unrivaled flexibility and capabilities to tackle the most difficult jobs on all sorts of terrain.

Marine Vessels



The company has 14 marine vessels including Tugs, Trawlers, work boats and barges, including two 74' and a 56' surplus military mechanized landing craft equipped with material handling cranes.

40 acres of Operational and Maintenance Facilities

To store and maintain this equipment, the company owns a 40 acre facility in Westport Island, ME

Additional Capabilities



In addition to the equipment mentioned above that the company owns, Chesterfield has the ability to augment its fleet of equipment and vehicles with other unique capabilities. For example, the company has done remote concrete pours and other construction in the middle of large bodies of water using helicopters.

Insurance and Bond Coverage

Chesterfield is fully insured with \$10M in general liability insurance to cover any occurrence.

For bonding coverage, the company has a \$12 million single limit; \$25 million aggregate limit program in place.

The company's employees are fully covered by Workmen's Compensation Insurance.

References

With over 50 years of service, Chesterfield Associates, Inc. has a long list of government and private references available upon request